

**STATE OF HAWAII
DEPARTMENT OF TRANSPORTATION
HIGHWAYS**

**ADDENDUM NO. 1
FOR
KUHIO HIGHWAY INTERSECTION IMPROVEMENTS,
VICINITY OF PINEAPPLE STORE
DISTRICT OF LIHUE
ISLAND OF KAUAI
PROJECT NO. 56A-03-25**

May 8, 2026

This Addendum shall make the following amendment(s) to the Solicitation:

A. PLANS

1. Delete **PLAN SHEET NO. 3 – GENERAL NOTES AND LEGEND** and replace it with attached **PLANS SHEET NO. ADD.3 - GENERAL NOTES AND LEGEND** dated r5/8/26.
2. Delete **PLAN SHEET NO. 22 – PAVEMENT MARKING & TRAFFIC SIGNING PLAN** and replace it with attached **PLAN SHEET NO. ADD.22 – PAVEMENT MARKING & TRAFFIC SIGNING PLAN AND LEGEND** dated r5/8/26.

The following is provided for information.

B. PRE-BID MEETING MINUTES

1. The attached **PRE-BID MEETING MINUTES AND ATTENDANCE LIST** are provided for information.

C. RESPONSES TO REQUESTS FOR INFORMATION (RFI'S/QUESTIONS)

1. The attached **RESPONSES TO REQUESTS FOR INFORMATION** are provided for information.

Please acknowledge receipt of this **ADDENDUM NO. 1** by recording the date of its receipt in the space provided on **PAGE P-4** of the Proposal.



ERIC FUJIKAWA
Program Manager

FED. ROAD DIST. NO.	STATE	PROJ. NO.	FISCAL YEAR	SHEET NO.	TOTAL SHEETS
HAWAII	HAW.	56A-03-25	2026	ADD.3	28

GENERAL NOTES

- The scope of work for this project includes widening of existing roadway to extend left-turn lane and construct storage lane; removing and installing pavement markings and traffic signs; removing and installing asphalt concrete curb and concrete swale; reconstructing graded drop inlet to storm drain manhole; cold planing and resurfacing; hydro-mulch seeding of graded shoulder.
- The Contractor is reminded of the requirements of Subsection 105.16 - Subcontracts.
- The Contractor's attention is directed to the following Sections of the Special Provisions: Subsection 107.06 - Contractor Duty Regarding Public Convenience; Subsection 104.11 - Utilities and Services; and Section 645 - Work Zone Traffic Control.
- Any work specified in the contract but not listed separately in the proposal schedule shall be considered incidental to other various contract items and shall not be paid for separately.
- The Contractor shall notify the Engineer in writing, two (2) weeks prior to starting operations.
- All lanes shall be open to traffic during morning peak hours from 6:30 A.M. to 8:30 A.M., during afternoon peak hours 3:30 PM to 6:30 P.M., and during off work hours. Only one lane of highway shall be closed at any other time. Failure of the Contractor to open all lanes of traffic during the times specified above shall result in assessment of rental fees as specified in Section 108.09 - Rental Fees for Unauthorized Lane Closure or Occupancy.

Work shall be performed at night between 8:30 P.M. and 5:00 A.M. of the following day, Sunday through Thursday, excluding holidays. Work outside off these hours are permissible when approved by the Engineer in writing.

The allowable lane closure hours during night work shall be as follows:

Sunday thru Thursday, 8:30 P.M. to 12:00 midnight
Monday thru Friday, 12:00 midnight to 5:00 A.M.

- All workers within the State right-of-way who are exposed to either vehicles using the roadway or to construction equipment shall wear high-visibility safety apparel that meets the requirements of ANSI/ISEA 107-2004, Performance Class 2 or 3. "Workers" is defined as people on foot whose duties place them within the State right-of-way, such as, but not limited to construction and maintenance forces, equipment operators, survey crews, utility crews, responders to incidents (e.g., EMT and firemen), and law enforcement personnel directing traffic, investigating accidents, handling lane closures and obstructed roadways.
- No material and/or equipment shall be stockpiled or otherwise stored within the highway right-of-way except at locations designated in writing and approved by the Engineer. If use of location is approved by the Engineer, the Contractor shall obtain a permit to use the property within the highway right-of-way from the State Highways Division at telephone no. 241-3000.
- The existence and location of underground utilities, manholes, monuments and structures as shown on the plans are from the latest available data but the accuracy is not guaranteed. The encountering of other obstacles during the course of work is possible. The Contractor shall be held liable for any damages incurred to the existing facilities and/or improvements as a result of his operations.
- Prior to construction, the contractor shall contact the various utility agencies for location of existing utilities within the project limits. The Contractor shall locate and protect all existing utilities whether or not shown on the plans. Any costs incurred by damages to existing utilities will be borne by the Contractor. Contractor shall request from One-Call Center, Ph: 1-866-423-7287. The Contractor shall also call the County of Kauai, Department of Water, Ph: 245-5411 and the Wastewater Division, Ph: 241-6642 for toning waterlines and sewerlines respectively.
- All works of toning, probing, hand digging and all other means of utility verifications shall not be paid for separately, but shall be considered incidental to the various contract items.

- The Contractor shall provide for access to and from all existing driveways, sidewalks and ADA access routes, and side streets and cross streets at all times. This work shall be considered incidental to the various contract items.
- Existing drainage system will be functional at all times during construction. The Contractor shall furnish materials, equipment, labor, tools and incidentals necessary to maintain flow. This work shall be considered incidental to the various contract items.
- Contractor shall exercise extreme caution to preserve all existing right-of-way centerline, as-built, construction, and NGS (horizontal and vertical in the NGS database) monuments located within the State of Hawaii right-of-way, if monuments are disturbed or destroyed, the Engineer shall be notified. Reconciliation to the Right-of-Way Baseline and/or boundary study and determination may be required prior to re-installation of the disturbed or destroyed monuments. The Engineer shall be contacted for guidelines and procedures prior to construction.

A State of Hawaii Licensed Surveyor shall perform the location and staking of the reset monument. The DOT Standard Plans and Specifications, with the exception of NGS monuments which shall have a NGS approved "brass disk" marker, shall be referenced for the monument type and materials.

Any NGS vertical monuments that are deemed necessary for relocation due to construction shall follow the NGS benchmark reset procedures written by Curtis Smith dated September 2010 or newer. All work must be done by an electronic digital level that is acceptable by NGS for second-order class one or higher work. The surveyor must use two one-piece invar barcode rods with current certifications with struts with 15 lbs turning plate or turtles; and/or turning pin with driving cap and temperature readings. Contact NGS prior to any work to ensure all equipments meets reset specifications. A State of Hawaii Licensed Surveyor shall perform the relocation. All work must be submitted both in electronic and hard copy formats to NGS and the Engineer.

All monument work shall be considered incidental to this project, unless noted otherwise.

- No sections where guardrail has been removed shall be left unattended at the end of each work day. Open sections shall be shielded by Portable Concrete Barrier or as directed by the Engineer. For Portable Concrete Barrier details, refer to Standard Plans TE-42 and TE-43. Furnishing, installing, and maintaining of these devices shall be considered incidental to the various contract items and will not be paid separately.
- All saw cutting work shall be considered incidental to various contract items and will not be paid separately.
- The Contractor, at his own expense shall hydro-mulch and maintain per Section 641 - Hydro-Mulch Seeding of the HDOT Standard Specification all areas disturbed by his operations.
- Trimming and dressing of shoulder, sidewalk and bus turnout shall consist of clearing, grubbing, grading, reshaping and compacting the unpaved shoulders with suitable material as shown on the plans and/or as directed by the Engineer. Suitable materials shall include materials from roadway excavation, including topsoil and base material therefrom, and if necessary, additional materials from borrow outside the limits of the right of way. Asphalt concrete removed from cold planing, reconstruction and roadway excavation shall not be used for dressing of shoulder, sidewalk or bus turnout. This work shall be considered incidental to the various contract items.
- Removal and disposal of existing reflector marker, steel and/or wood posts, rail elements, and end treatments including concrete foundations, and backfilling of resulting holes shall be considered incidental to the various contract items and will not be paid separately.

ORIGINAL PLAN	SURVEY PLOTTED BY	DATE
NOTE BOOK	DRAWN BY	
QUANTITY BY	DESIGNED BY	
CHECKED BY	ADD.3	

r5/8/26	△ -	Revise Note No. 15
DATE	REVISION	
STATE OF HAWAII DEPARTMENT OF TRANSPORTATION HIGHWAYS DIVISION		
<u>GENERAL NOTES AND LEGEND</u>		
<u>KUHIO HIGHWAY INTERSECTION IMPROVEMENTS</u>		
Vicinity of Pineapple Store Project No. 56A-03-25		
Scale: N/A	Date: May 2026	
SHEET No. 1 OF 2 SHEETS		

FED. ROAD DIST. NO.	STATE	PROJ. NO.	FISCAL YEAR	SHEET NO.	TOTAL SHEETS
HAWAII	HAW.	56A-03-25	2026	ADD.22	28

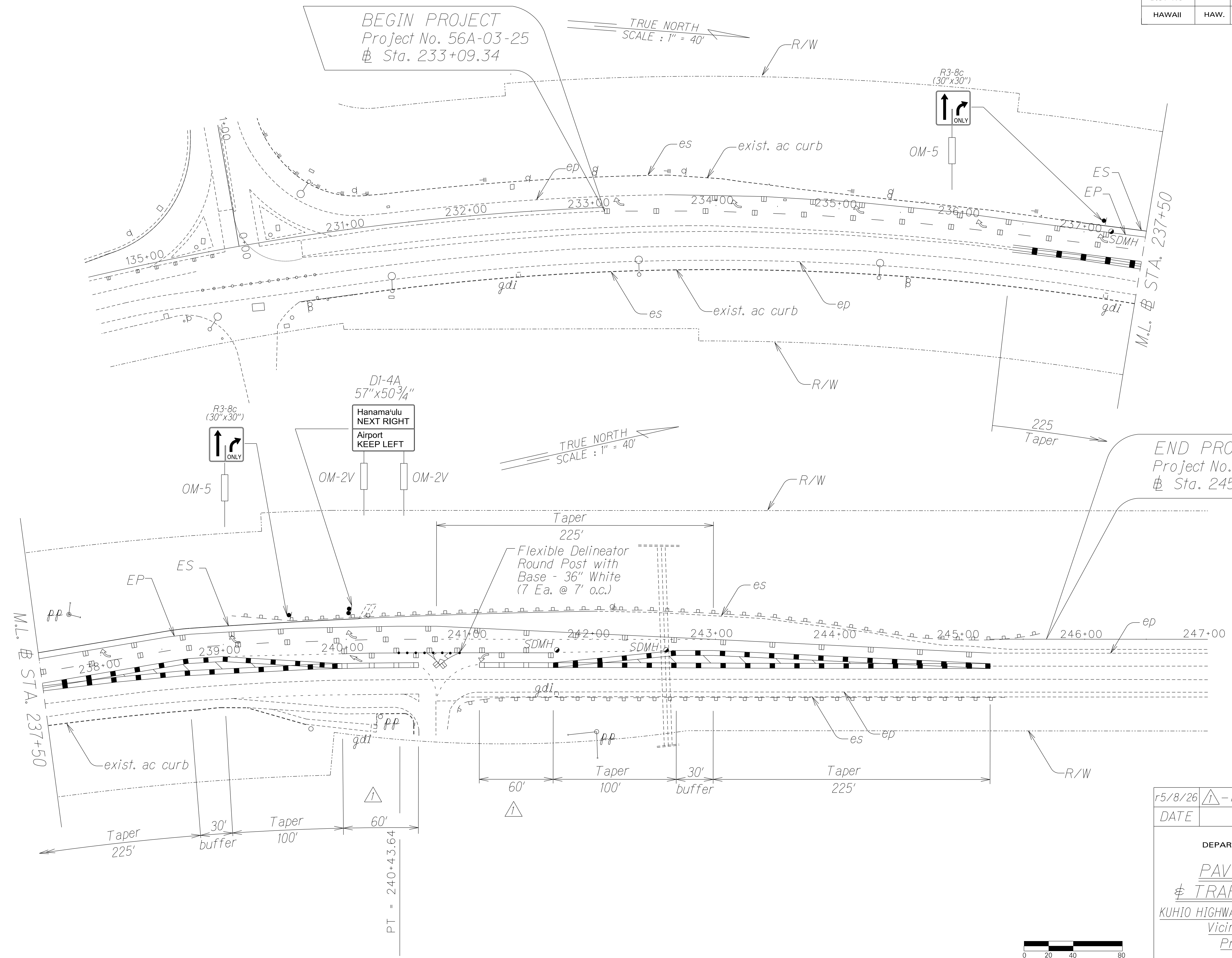

BEGIN PROJECT
Project No. 56A-03-25
Sta. 233+09.34

END PROJECT
Project No. 56A-03-25
Sta. 245+68.87

SURVEY PLOTTED BY	DATE
DRAWN BY	
DESIGNED BY	
QUANTITIES BY	
CHECKED BY	
ORIGINAL PLAN	
NOTE BOOK	
NO.	

r5/8/26	△ - Revise length of storage lane
DATE	REVISION
STATE OF HAWAII DEPARTMENT OF TRANSPORTATION HIGHWAYS DIVISION	
PAVEMENT MARKING TRAFFIC SIGNING PLAN	
KUHIO HIGHWAY INTERSECTION IMPROVEMENTS Vicinity of Pineapple Store Project No. 56A-03-25	
Scale: 1" = 40'	Date: May 2026
SHEET No. 1 OF 1 SHEETS	

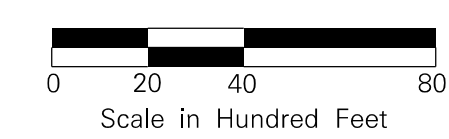

MINUTES OF THE PRE-BID MEETING

PROJECT: Kuhio Highway Intersection Improvements,
Vicinity of Pineapple Store
District of Lihue, Island of Kauai

PROJECT NO.: 56A-03-25

LOCATION: Microsoft Teams Video Conference

DATE & TIME: April 22, 2026 at 10:00 A.M.

IN ATTENDANCE:

Joel Bautista	HDOT – HWY-K
Bernie Vargas	HDOT – HWY-K
Janil Ke	HDOT – HWY-K
Kimi Holcomb	Earthworks Pacific
Kaipolani Mochizuki	Grace Pacific, LLC
Jason Ames	Grace Pacific, LLC
Ralph Cushnie	Cushnie Construction
Chris Tavares	Goodfellow Bros. LLC
Tristan Gonzales	Goodfellow Bros. LLC
Ryan Moura	Goodfellow Bros. LLC
Skye Virtudes	Operating Engineers

HDOT Project Manager, Joel Bautista asked attendees to type in their name, business, email and contact number in the chat and began the meeting at 10:03 A.M. He noted anything said at this meeting shall be for clarification purposes only, the bid documents on HiePRO shall govern over anything said today. All questions resulting from this meeting are to be submitted through HiePRO and will be answered through an addendum. Questions received after the deadline will not be addressed. Contract dates on HiePRO are for estimation only.

Joel introduced the project and gave a brief overview of the project. He then opened the meeting to questions.

The following questions were raised:

Question #1: Will all work have to be completed at night?

Response: Day work is allowed. However, should the work require lane closures, night work will be required.

Question #2: How will day work be affected by the Contra-flow.

Response: Contra-flow hours will have to be considered. No lane closures during contra-flow hours.

Question #3: Will concrete barriers be required for lane closures?

Response: This will be looked into and answered via addendum.

Question #4: If concrete barriers are required, can the State provide the barriers?

Response: This will be looked into and answered via addendum.

Joel noted that the bid opening is on May 15th and emphasized that any questions must be submitted no later than May 1st.

Joel asked if there were any other questions. With no further questions or comments, the pre-bid meeting was adjourned at 10:10 A.M.

The minutes of the meeting will be distributed in Addendum No. 1 of the Contract Plans. Contractors will be notified via HiePRO when the addendum will be available.

Kuhio Highway Intersection Improvements, Vicinity of Pineapple Store
Project No. 56A-03-25
PRE-BID MEETING ATTENDANCE
April 22, 10:00 A.M., Microsoft Teams Video Conference

10:00 AM

Janil Ke, HDOT, janil.ke@hawaii.gov, (808) 241-3027,
Joel Bautista, HDOT, joel.o.bautista@hawaii.gov, (808) 241-3015

- Kimi Holcomb 10:00 AM

KH Kimi Holcomb, Earthworks Pacific, kimi@earthworkspacific.com, 808.246.8808
- Jason Ames was invited to the meeting.
- Ryan Moura 10:01 AM

RM Ryan Moura, Goodfellow Bros. LLC., 808-298-2431
- Vargas, Bernie P 10:01 AM

BV Bernie Vargas, HDOT, bernie.p.vargas@hawaii.gov, 808 241-3018
- Tristan Gonzales 10:01 AM

TG Tristan Gonzales, Goodfellow Bros. (808) 462-8057
- Jason Ames 10:02 AM

JA Jason Ames, Grace Pacific LLC JAmes@gracepacific.com 808-520-6335
- Chris Tavares 10:02 AM

CT Chris Tavares, Goodfellow Bros. 808-645-1950 christ@goodfellowbros.com
- Ralph Cushnie 10:02 AM

RC Ralph Cushnie
Cushnie Construction
Ralph@cushniecci.com

8086450955
- Skye Virtudes 10:04 AM

SV Skye Virtudes
Operating Engineers
8085833711
skye@hoeisf.com
- Kaipolani Mochizuki 10:04 AM

KM Kaipolani Mochizuki, Grace Pacific
(808) 294-9067, kchang@gracepacific.com

Responses to Request for Information (RFI's/Questions)
HIePRO Questions for solicitation B26000628
Kuhio Highway Intersection Improvements,
Vicinity of Pineapple Store
Project No. 56A-03-25
As of May 8, 2026

1. Will concrete barriers be required for lane closures?

RESPONSE : Depending on contractor means and methods and the approved traffic control plan, work zone traffic control for lane closures may include barricades. See General Note 15 and Work Zone Note 1 of the construction plans. Additionally, drop-off sections that are beyond OSHA safety restrictions and unattended at the end of each work day shall be shielded by constructing 3:1 (or flatter) temporary taper or as directed by the Engineer. This work shall be considered incidental to various contract items and will not be paid separately.

2. If concrete barriers are required, can the State provide the barriers?

RESPONSE: No, all State owned concrete barriers are being mobilized throughout the island. There is no guarantee of availability for the duration of this project.

4. Is there a pre-bid meeting attendees list?

RESPONSE: Yes. This will be provided in Addendum No. 1.

5. Are you requiring union labor for this project, or can both union and non-union Contractors participate.

RESPONSE: Yes, both union and non-union can participate in this project.